

BTE-02/03/04

Single Port BNC to RJ-45 / RJ-11 / Terminal Block Exchanger

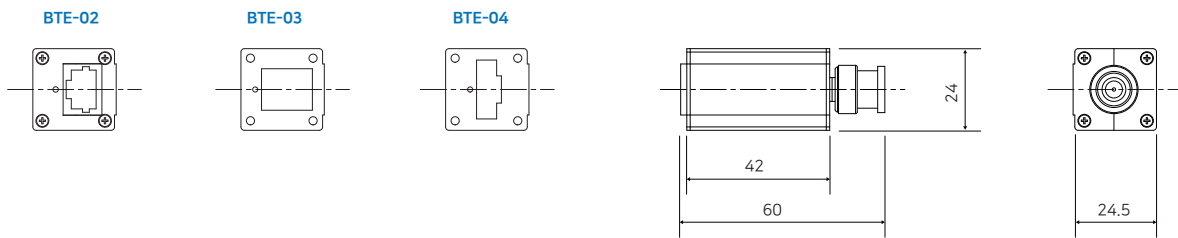

Dimension



Overview

BTE-02/03/04 is BNC to RJ-45 / RJ-11 / 2-Pin Terminal Block Exchanger that supports B-Linx signal and power transmission over UTP cable / Telephone wire / any kind of 2-Wire cable.

This exchanger works with Intercoax ECP series exclusively to use various new or existing cables in the field instead of Coaxial cable and it maintains optimum B-Linx signal without interference using impedance matching technology.

Features

- BNC to RJ-45 (4 Pair cable) / RJ-11 (2 Pair cable) / Terminal block (1 Pair cable) Exchanger.
- Specialized Impedance Matching Technology (Maintain optimum signal without interference).
- Crosstalk cancellation Technology
- Power LED indication
- Exclusively compatible with Intercoax ECP-28XX, 27XX, 95XX, 84XX, 83XX series.

Specification

Model		BTE-02	BTE-03	BTE-04
Interface	Coax	75Ω BNC (Male) - Ethernet over Coax		
	Pair cable	RJ45 (4 Pair)	RJ11 (2 Pair)	2-Pin Terminal Block (1 Pair)
LED Indication	Power	Blue On: Normal		
Power	Max. Current (W)	Up to 60W power over cable		
Mechanical	Dimension	60(L) x 24(W) x 24.5(H)mm		
	Weight	30g		
Environment	Operating Temp	-20 ~ 60°C		
	Storage Temp	-40 ~ 80°C		
	Relative Humidity	0% ~ 95%		

Performance chart (with BTE-02)

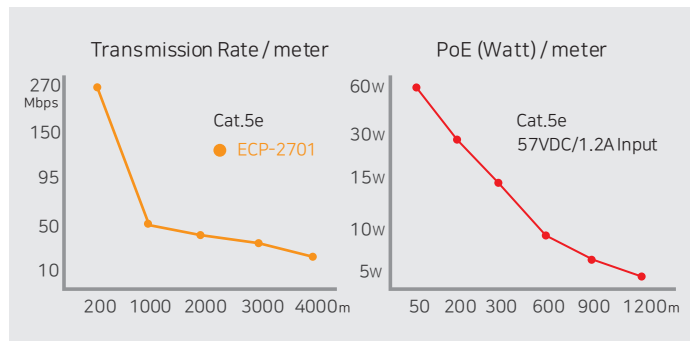

Connection Diagram

